

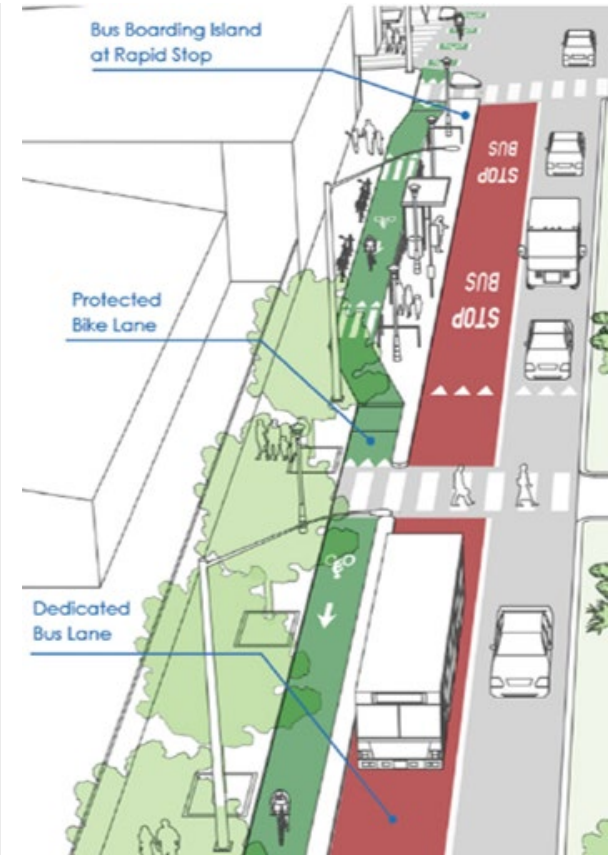

San Pablo Avenue Parallel Bike Improvements Project



Project Plan Excerpts

December 2025

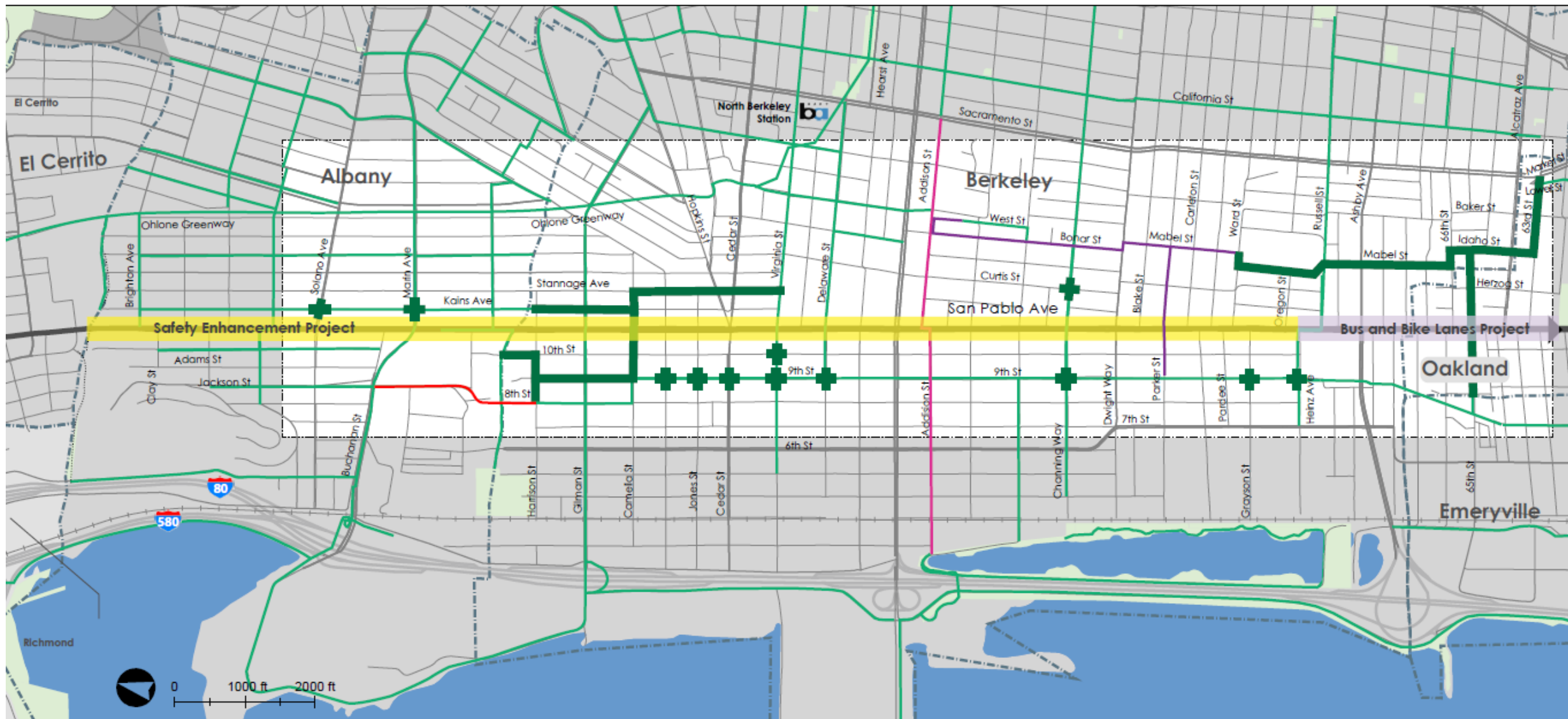

City Boundary
Parallel Bike Project Area
Safety Enhancement Project
Bus and Bike Lanes Project



Existing Bicycle Network
Parker-Addison Mobility and Safety Improvements Project (to be completed by others)
San Pablo Avenue Parallel Bike Improvements - Jackson Street Project



Addison Street Bicycle Boulevard Project
Parallel Bike Improvements

The plan view shows the intersection of Solano Ave and Kains Ave. Key features include:

- Proposed RRFB Location:** Indicated by a dashed line across the intersection, with a callout to 'SEE SHEET E-01 FOR SIGNAGE DETAILS'.
- Existing Features:**
 - EX. R6-1 (LEFT) and EX. R6-1 (RIGHT) signs.
 - EX. R5-1 and EX. R1-1 signs.
 - EX. RS-044 (MOD) & W13-1P sign.
 - EX. BUS STOP FLAG.
 - EX. YELLOW CURB TO REMAIN (50').
- Dimensions:** Various street widths and offsets are noted, such as 27', 36', 31', 22', 14', 20LF, 12LF, 13LF, 38A 90LF, 36' 40LF, 13' 14LF, and 20LF.
- Callouts:**
 - 'New flashing beacon' points to a location on Solano Ave.
 - 'Bike detection and advanced waiting area' points to a location on Kains Ave.
 - 'SEE DETAILS.' is repeated in several locations.
- Other Labels:** 'SOLANO AVE', 'KAINS AVE', 'W 606SF', and '606SF' are also present.

[illegible]

Harrison St (8th St to 10th St)

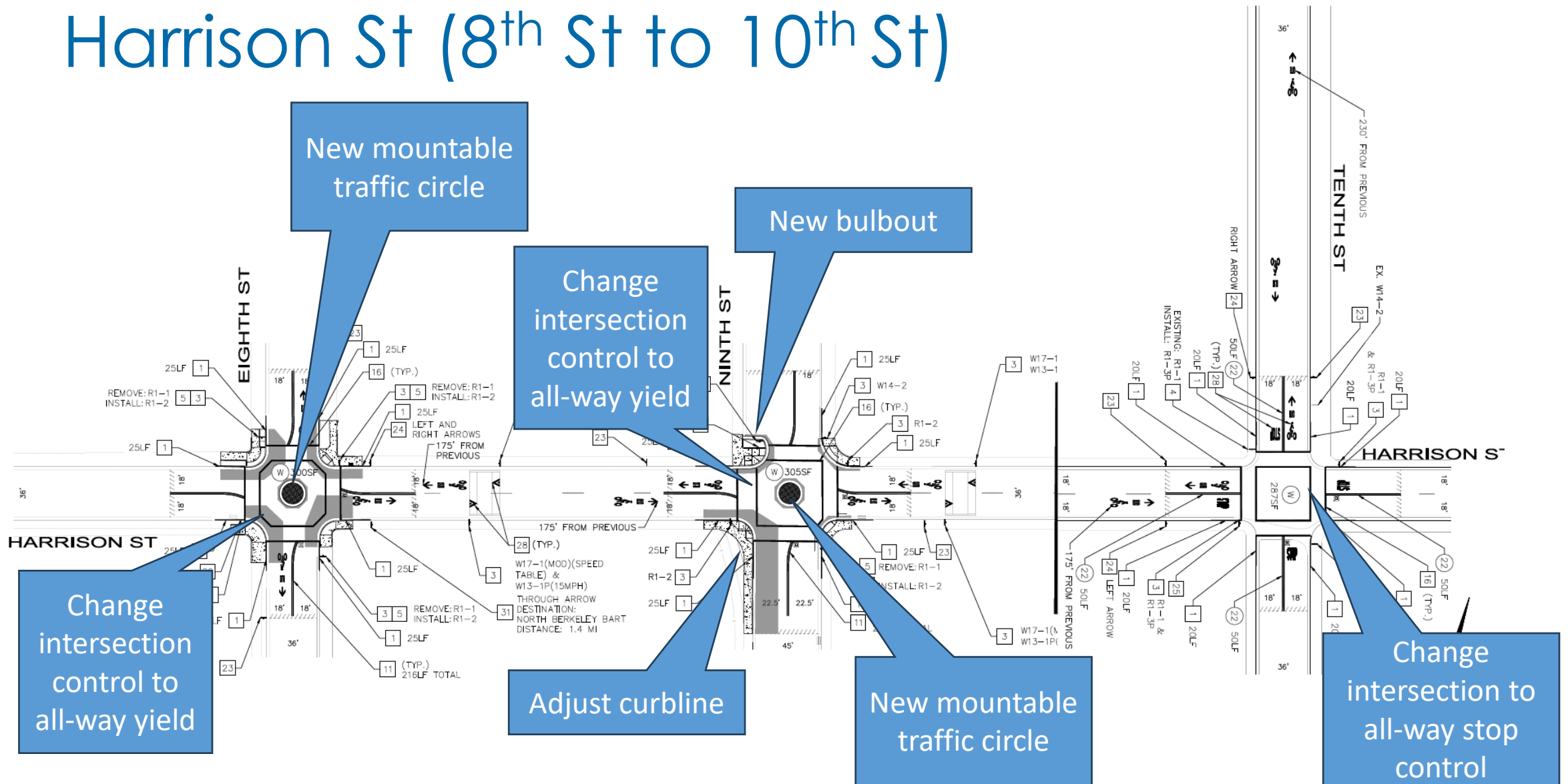

Ninth St (S/O Harrison St to N/O Camelia St)

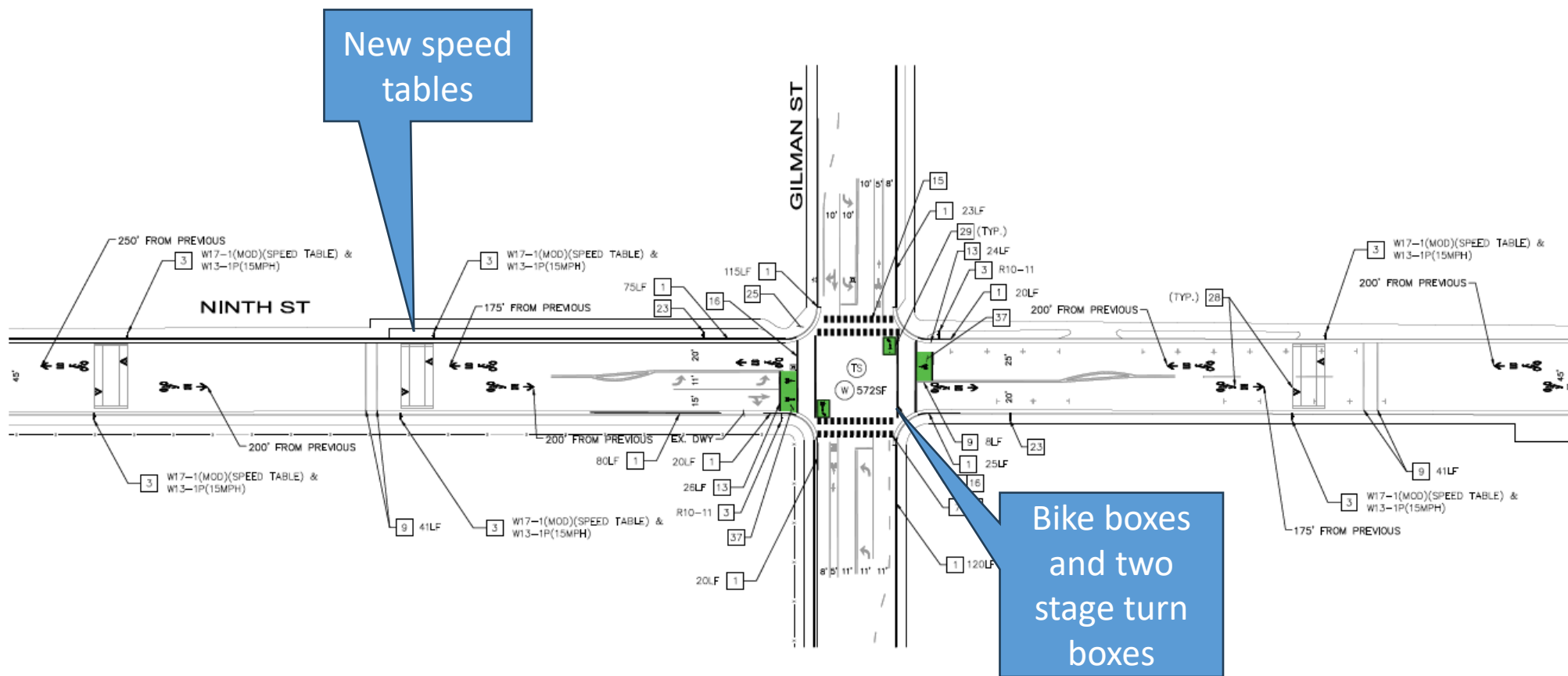

Camelia St (9th St to San Pablo Ave)

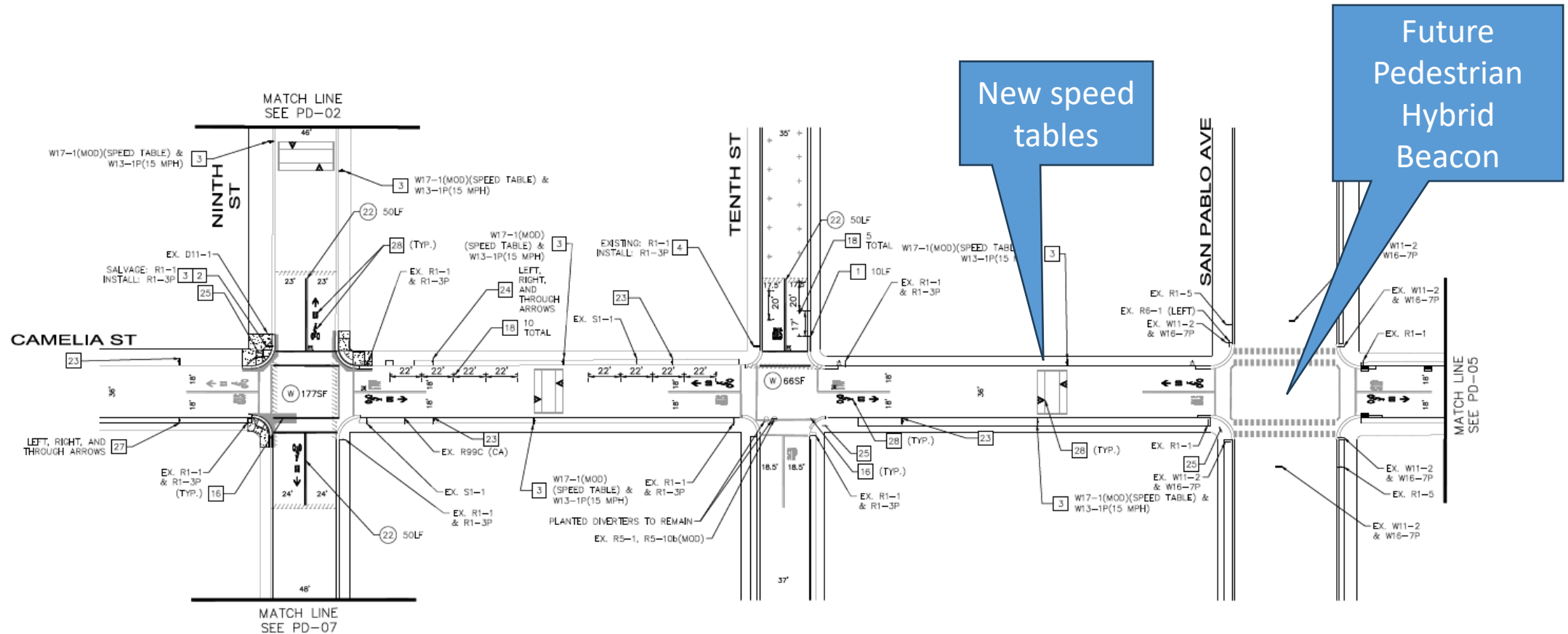

Ninth St (S/O Camelia St to Cedar St)

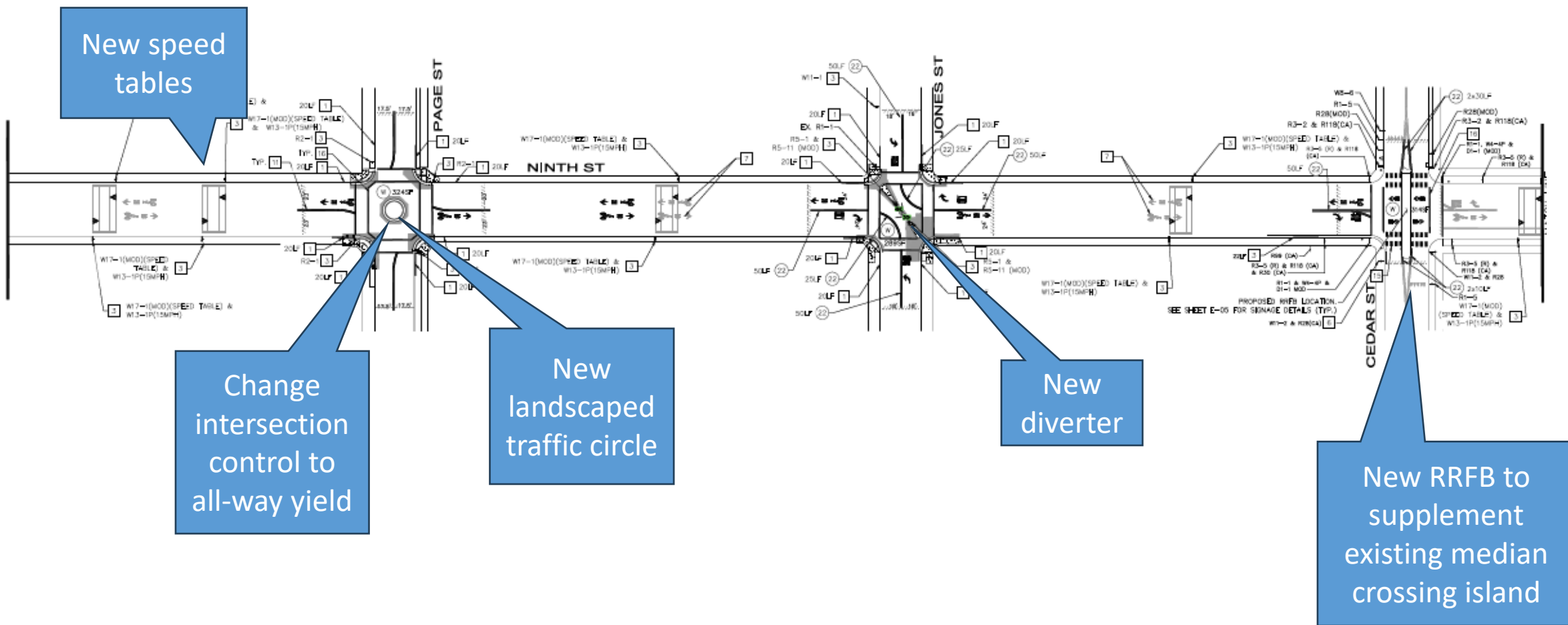

Ninth St (s/o Cedar St to Delaware St) & Virginia St (9th St to San Pablo Ave)

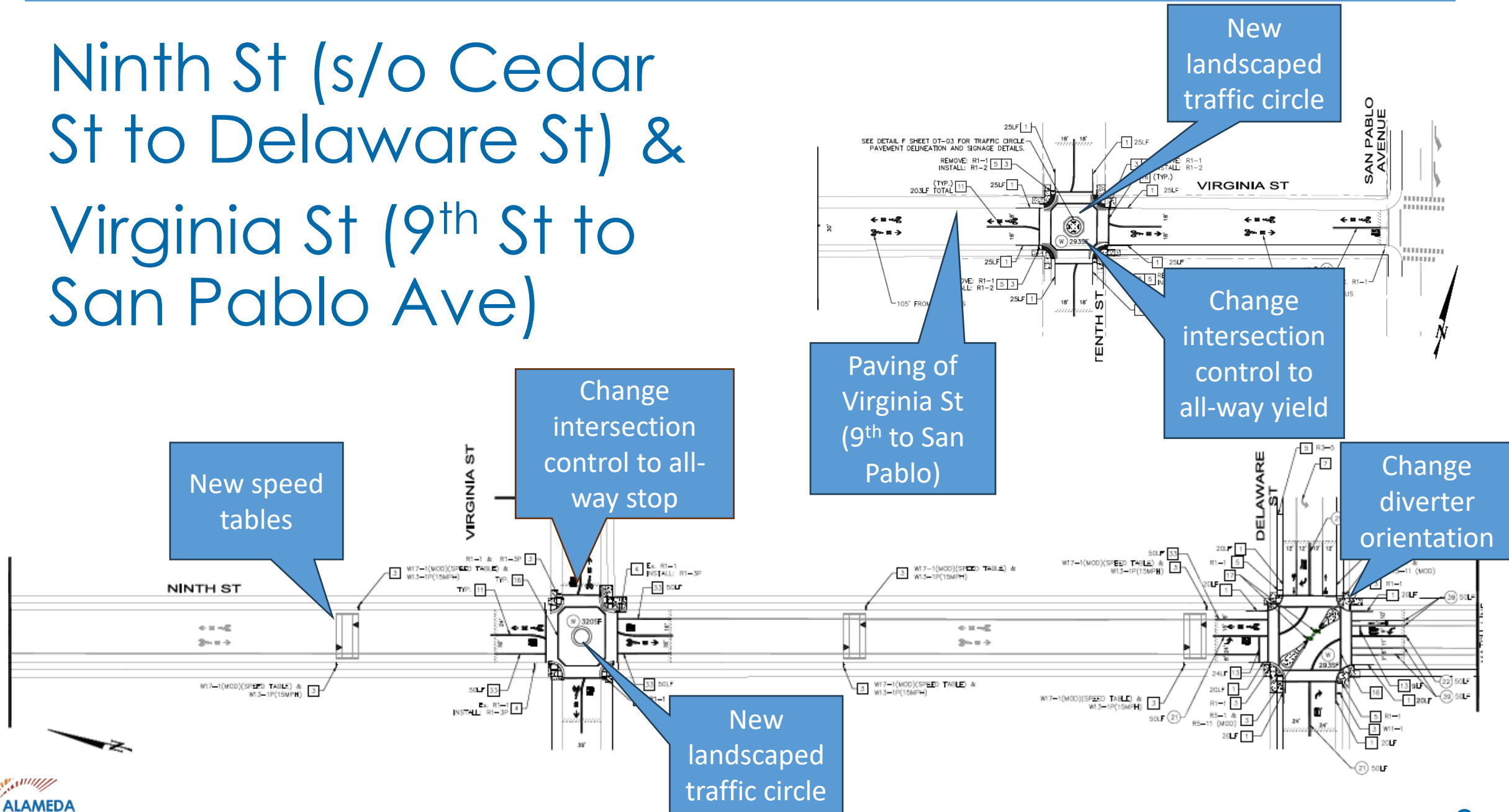

Ninth St (n/o Hearst Ave to University Ave)

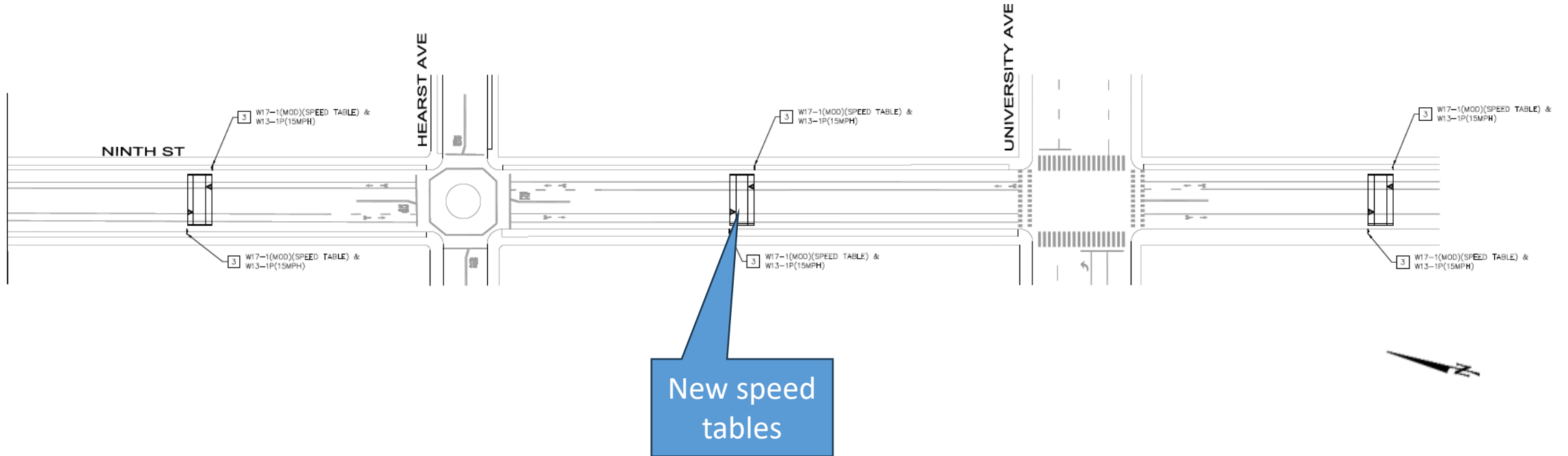

Ninth St (s/o Bancroft Ave to n/o Dwight Ave)

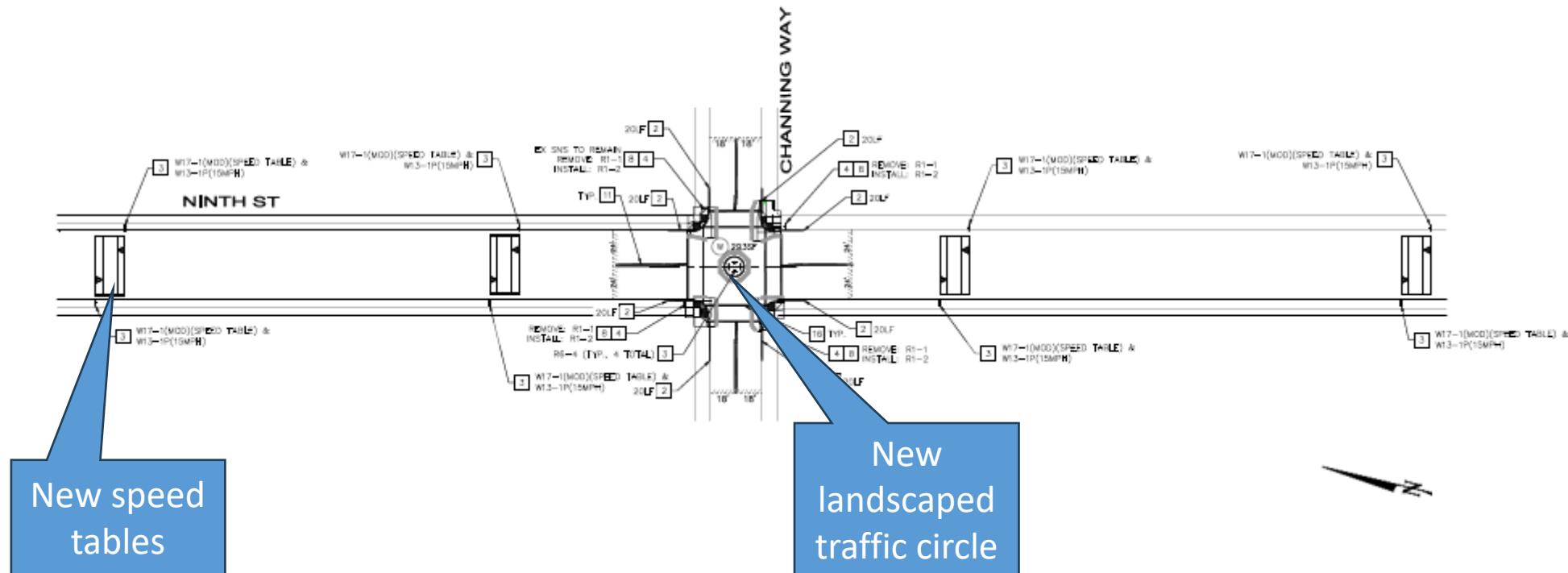

Kains Ave (Harrison St to Gilman St)

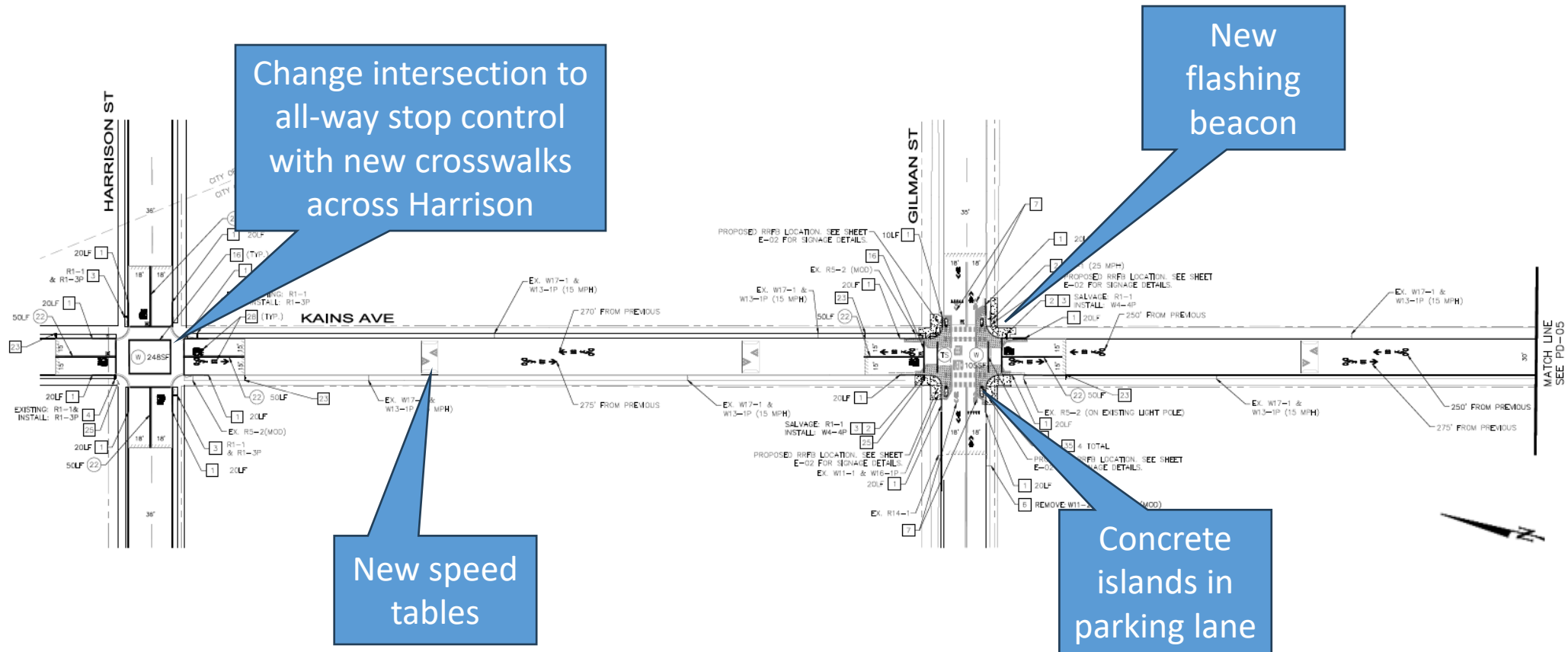

Kains Ave/Stannage Ave (Camelia St to s/o Jones St)

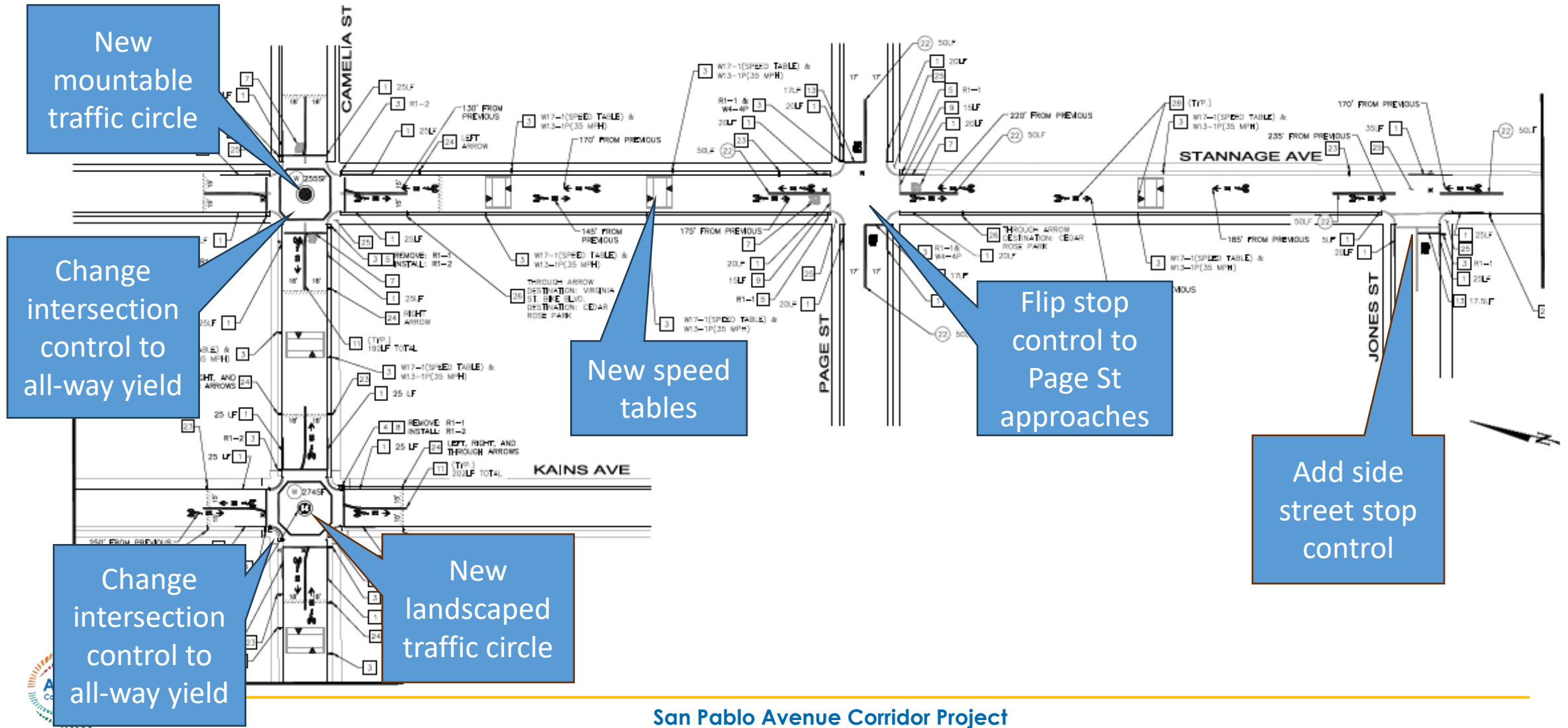

Stannage Ave (n/o Hopkins St to Virginia St)

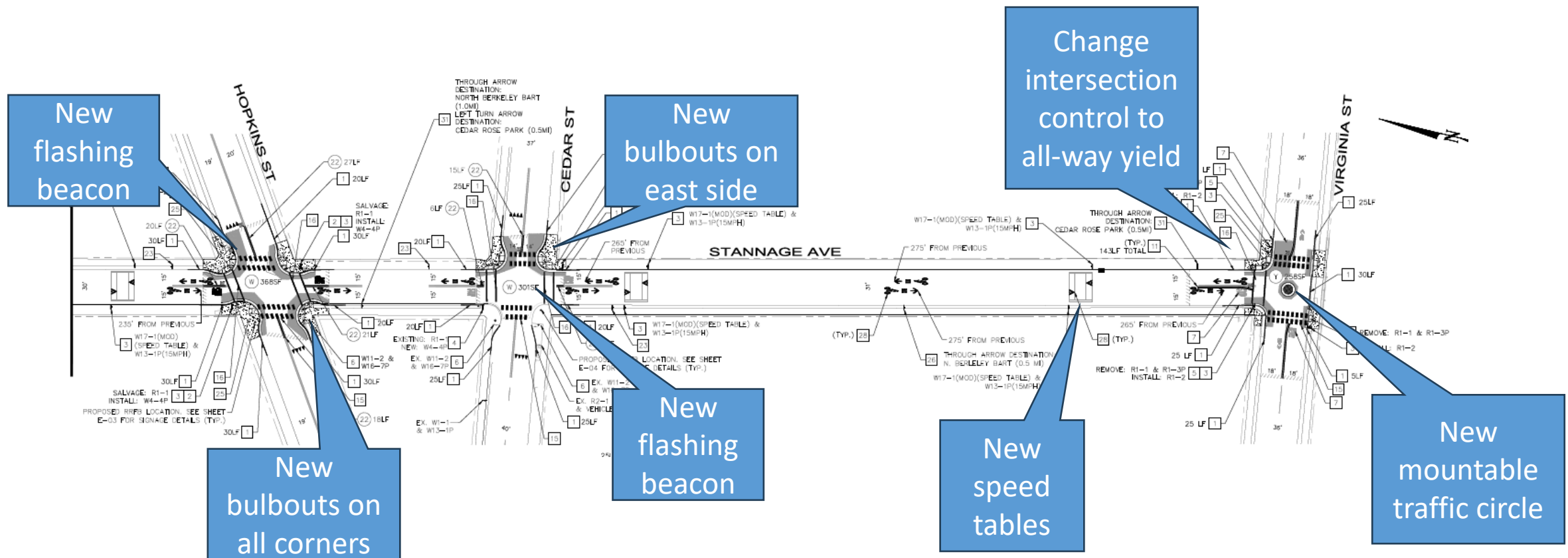

15



Ninth/Grayson and Ninth/Heinz

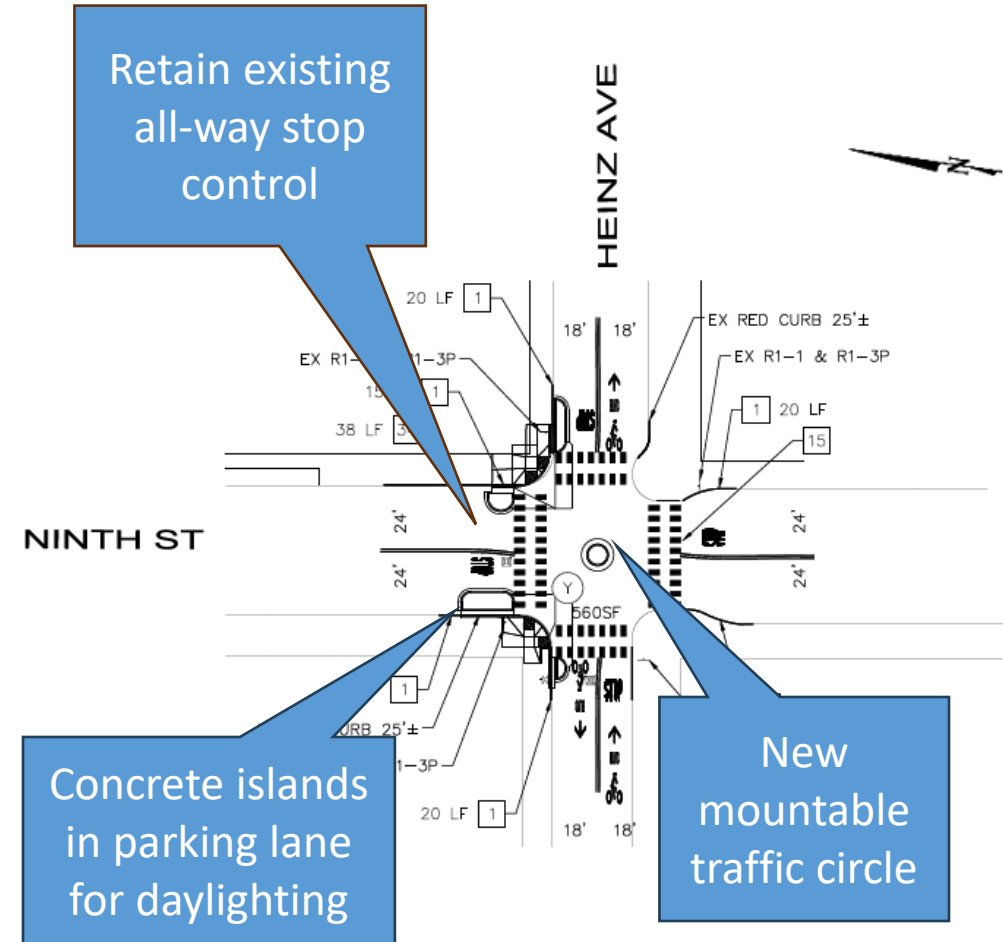
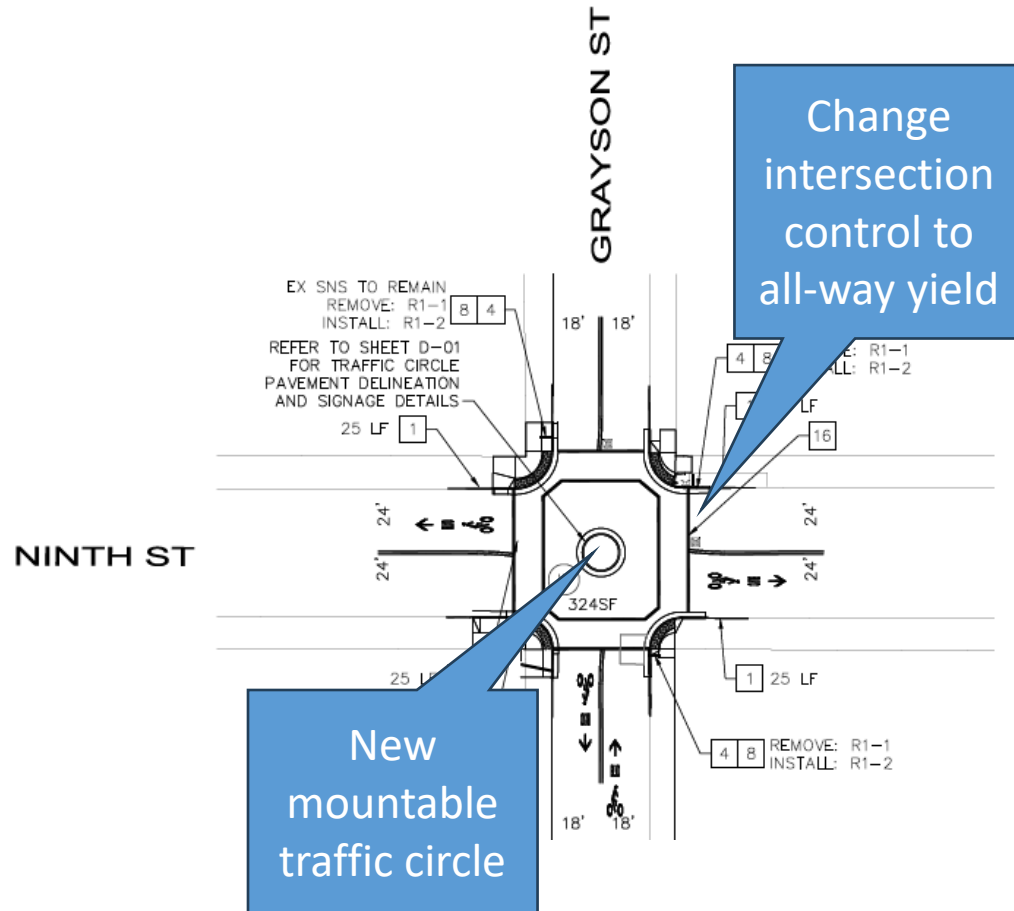

Mabel St (Ward St to s/o Oregon St)

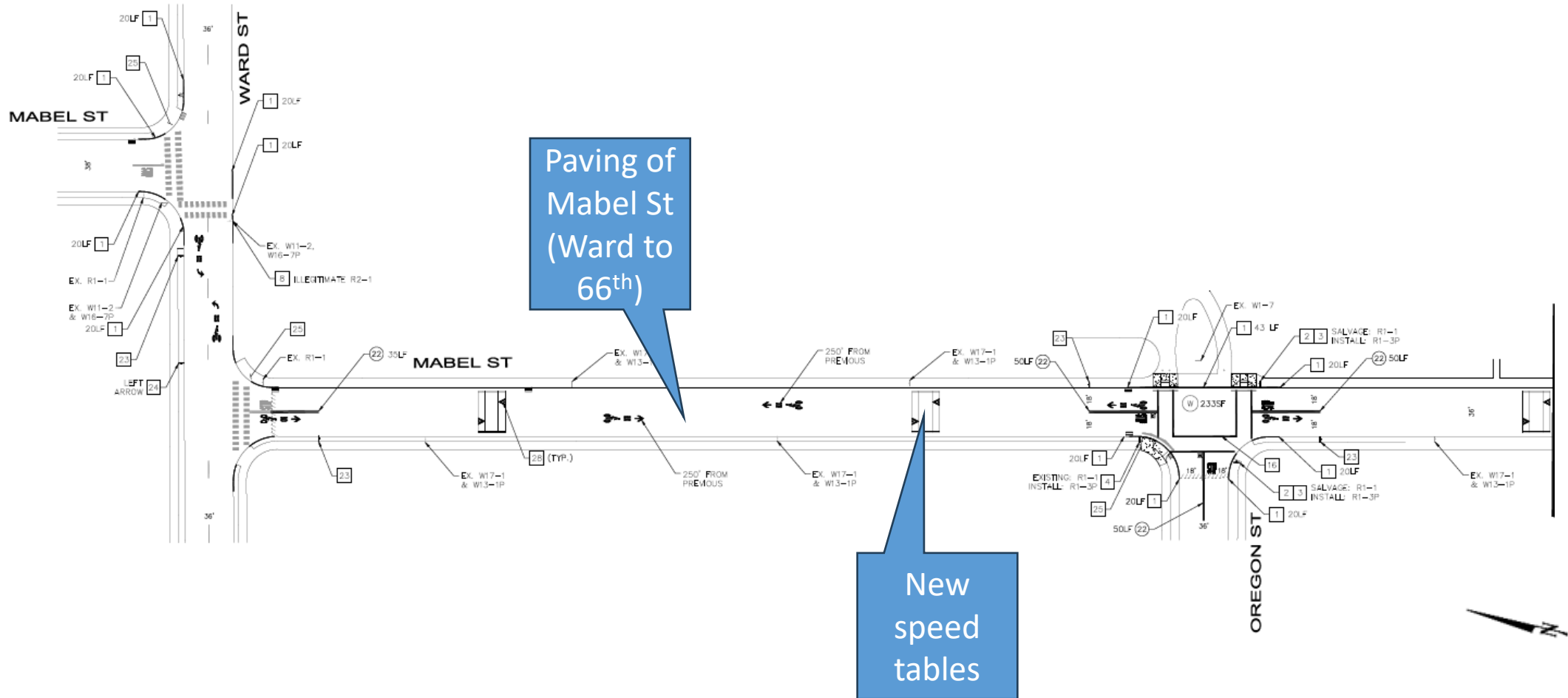

Mabel St (s/o Oregon St to Ashby Ave)

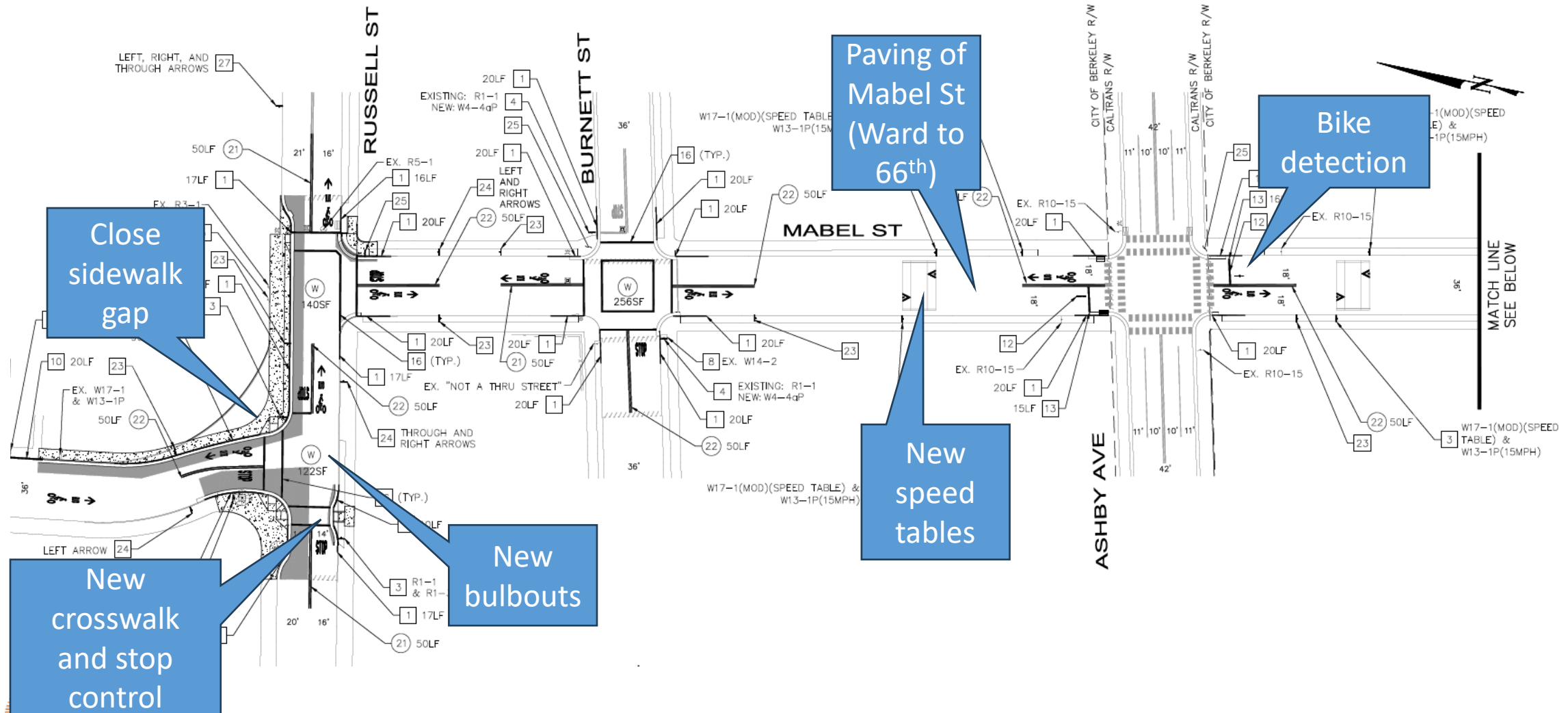

New speed tables

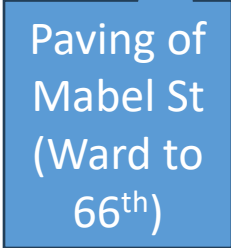

Mabel St/Idaho St – 66th St
to 65th St &
65th St – e/o San Pablo Ave
to Idaho St

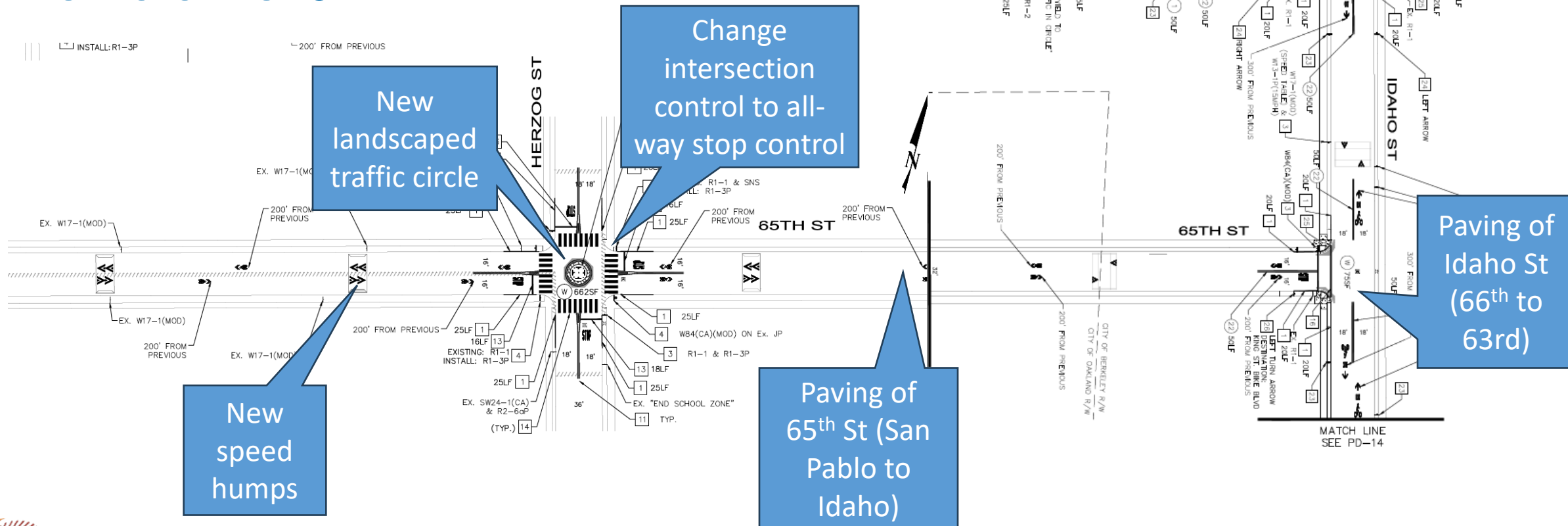

Idaho St (Harmon St to 63rd St)

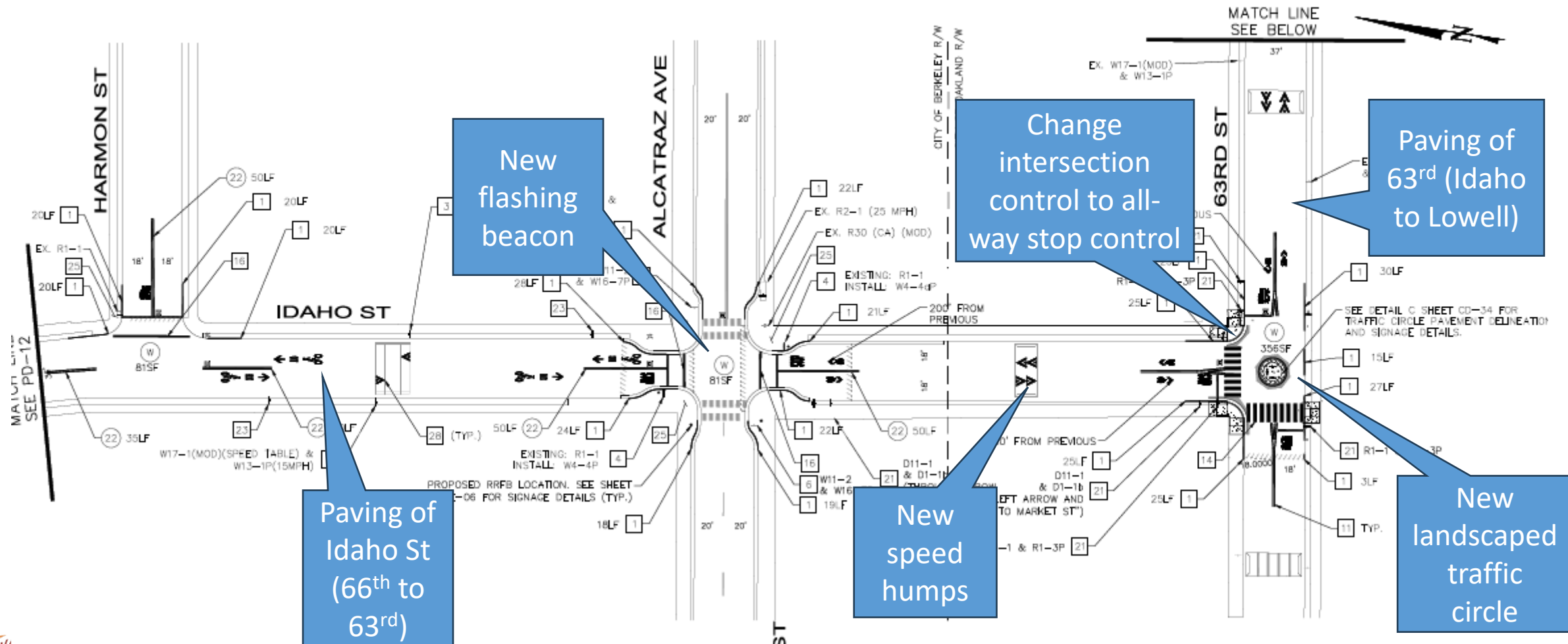

63rd St (e/o Idaho St to Sacramento St/ Market St)

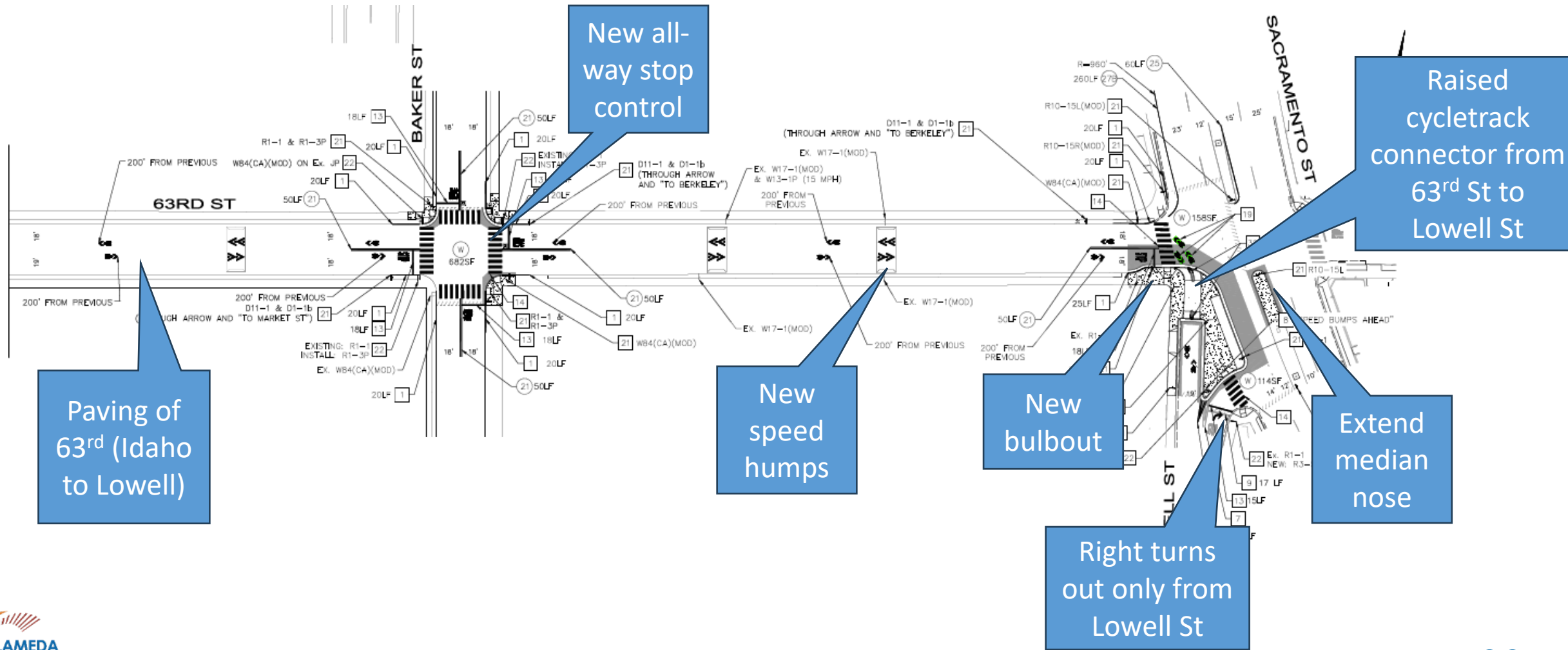

65th St (Emeryville Greenway to San Pablo Ave)

