



Traffic Advisory

Date: June 26, 2023
District: Four - Oakland
Contact: Janis Mara
Email: Janis.Mara@dot.ca.gov

FOR IMMEDIATE RELEASE

Full Closure of State Route 84 in Niles Canyon between Palomares Road in Fremont to Main Street in Sunol on Weekend of July 14-17, 2023

ALAMEDA COUNTY—Caltrans has scheduled to close State Route 84, also known as Niles Canyon Road, in both directions from Palomares Road in Fremont to Main Street in Sunol for the entire weekend of July 14-17, 2023, for work on the Alameda Creek Bridge.

Niles Canyon Road will be completely closed in both directions beginning at 8:00 PM on Friday, July 14, and will be reopened to traffic on Monday at 5:00 AM, July 17, 2023. In the case of unanticipated developments, the closure will be rescheduled and the public will be notified.

Portable changeable message signs will be placed prior to closure advising motorists of this closure and will stay in effect during the closure.

During this closure, crews will work around the clock to connect the existing roadway with the new roadway leading to the new Alameda Creek Bridge. The work includes grinding the pavement, laying down hot mix asphalt and rubberized asphalt paving, and striping the roadway.

Once the tie-in roadway work is paved, striping will be placed, and the road will be opened to traffic with the new Alameda Creek Bridge

Caltrans thanks motorists and residents for their patience as we work to maintain and improve the Bay Area's highways, bridges and tunnels.



BE WORK ZONE ALERT



Detours:

Traffic from Palomares Road

Via: WB Rte 84 (Niles Canyon Rd)
SB Rte 238 (Mission Blvd)
On-Ramp to NB Rte 680; NB Rte 680
Off-Ramp to EB Rte 84

Traffic from SB Rte 238 (Mission Blvd)

Via: Continue SB Rte 238.
On-Ramp to NB Rte 680
NB Rte 680
Off-Ramp to EB Rte 84

Traffic from Sunol and Pleasanton Sunol Rd

Via: EB Rte 84 (Niles Canyon Rd)
On-Ramp to SB Rte 680
SB Rte 680.
Off-Ramp to NB Rte 238 (Mission Blvd)
NB Rte 238
WB Rte 84

Traffic from SB Rte 680 and WB Rte 84

Via: Continue SB Rte 680
Off-Ramp to NB Rte 238 (Mission Blvd)
NB Rte 238

(Map on next page)



BE WORK ZONE ALERT



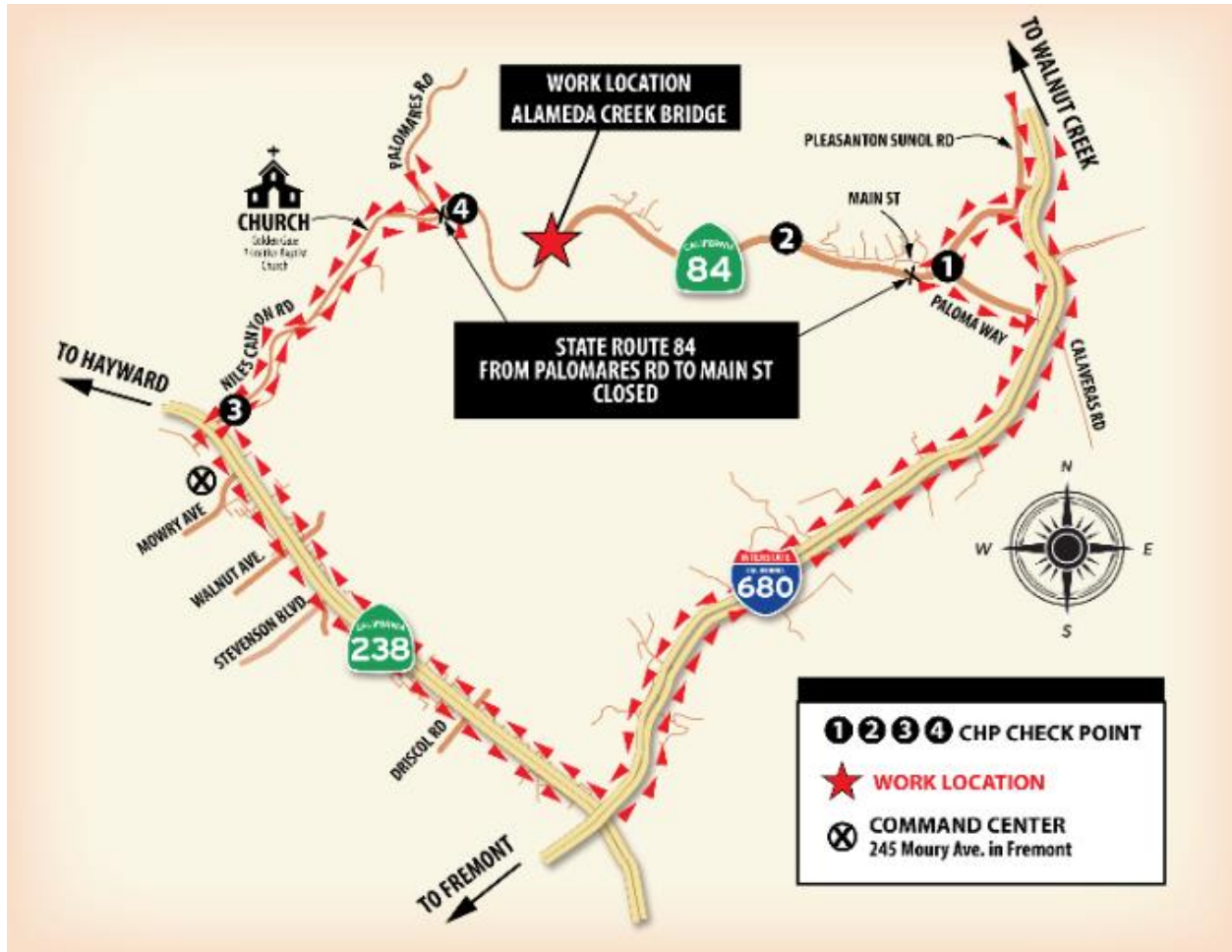

Save Our Water 

Learn easy ways to save water during California's drought at SaveOurWater.com

BE WORK ZONE ALERT

