

# I-80 GILMAN

## I-80/Gilman Street Interchange Improvement

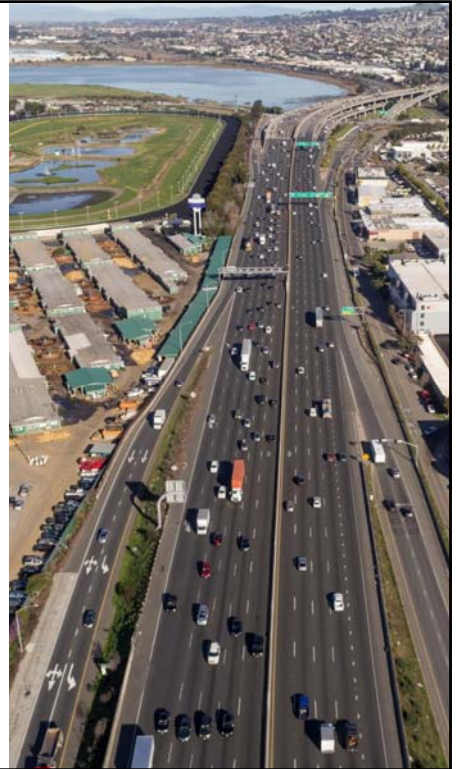

Presented to  
Programs and Projects Committee  
April 12, 2021



## Project Overview

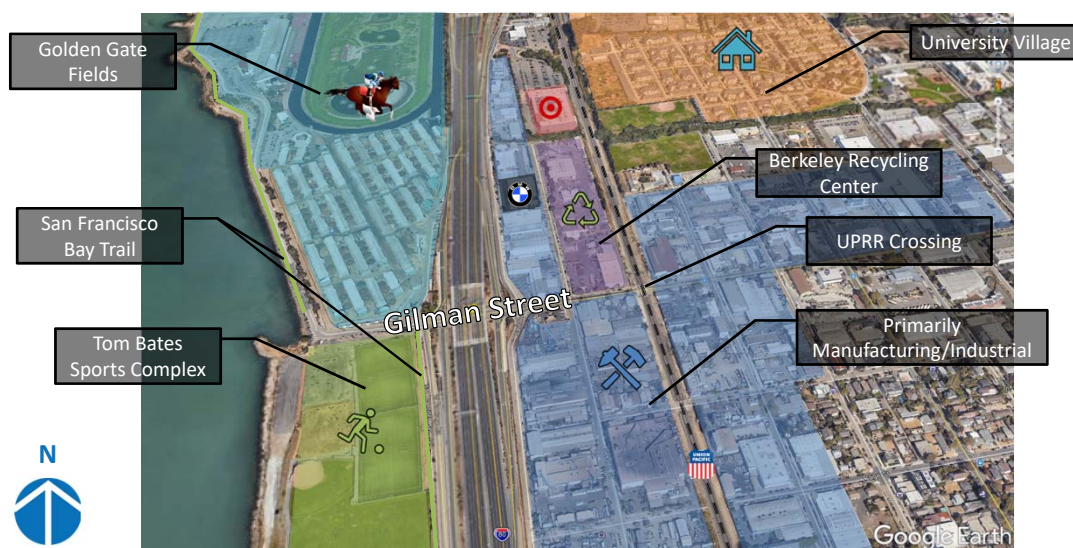

For illustrative purposes only.

## Project Overview

- » **Two roundabouts**
  - Landscaped areas
  - Modified access to Golden Gate Fields stables
  - Change in access from Gilman to Eastshore Highway
- » **Pedestrian/bike overcrossing (POC) over I-80 to the south**
- » **Sidewalks and at-grade path through interchange**
- » **Pedestrian/bike from Tom Bates Complex to Cordonices Creek**
  - Gilman Street cycle track to new signal at Fourth Street
  - Bike improvements from Gilman/Fourth Street to Codornices Creek
- » **Bay Trail gap closure at foot of Gilman Street**

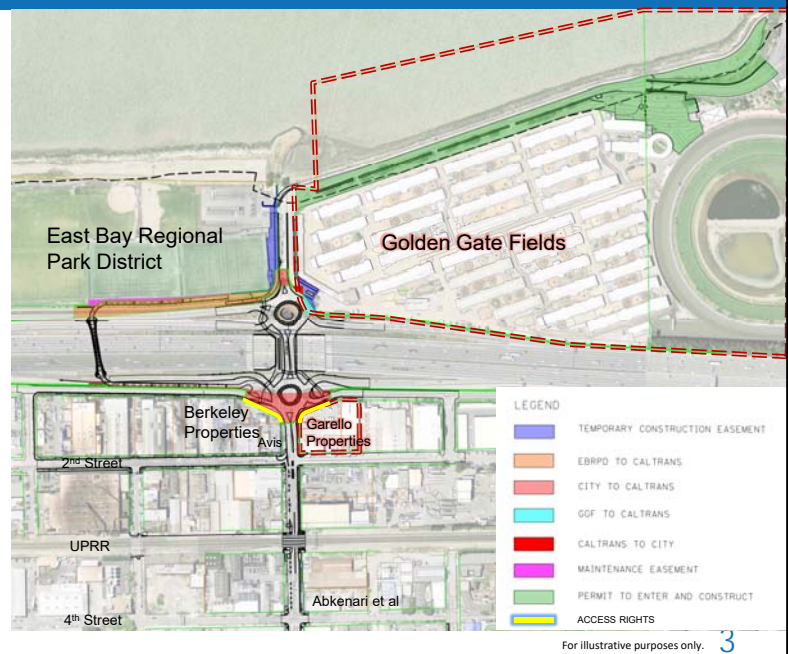

## Phase 1- Pedestrian/Bicycle Overcrossing (POC)

### Key Elements

- 230' steel arch bridge with CIP post tension concrete deck
- 8 approach spans (max. 117' long) reinforce concrete box deck
- 8 bents on CIDH Piles
- 4 approach retaining walls (70'-180') with lightweight concrete back fill
- Minor road improvements
- Close coordination with Tom Bates Regional Sports Complex, Golden Gate Fields, East Bay Regional Park District and the City of Berkeley

Visual simulation from Interstate 80 Eastbound looking north.



Visual simulation from Bay Trail southwest of Gilman Street.

For illustrative purposes only. 4



# Phase 1- POC Stage Construction

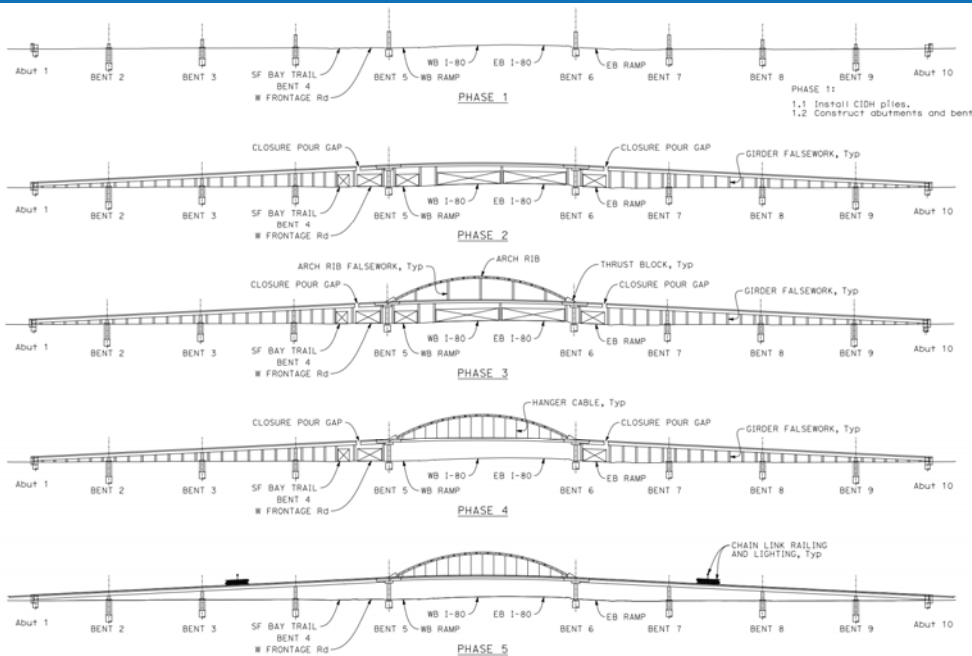

1: CIDH piles and bents

2: Install Falsework

3: Erect arch rib

4: Install hanger cables

5: Remove falsework. Install approaches, lighting, etc.

For illustrative purposes only.

5

# Phase 2 – Gilman Interchange

## Key Elements

- 2 roundabouts
- Bay Trail gap closure at the foot of Gilman Street
- A new traffic signal at Gilman and 4th Streets
- Union Pacific Railroad (UPRR)/Gilman Street crossing improvements and signal interconnect
- Closure of UPRR crossing at Camelia Street
- 2 cantilever soldier pile retaining walls (125'-190')
- Architectural curtain wall
- Landscaping
- City of Berkeley Sewer Line
- EBMUD Recycled Water Line

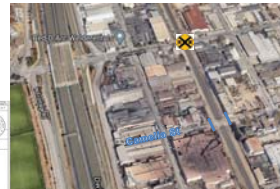
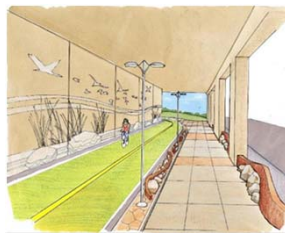
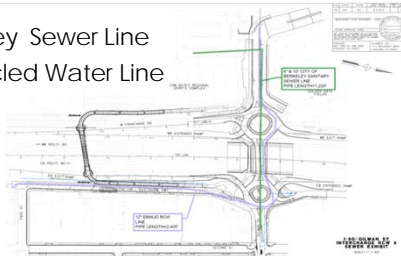

For illustrative purposes only.

6

# Cost Factors

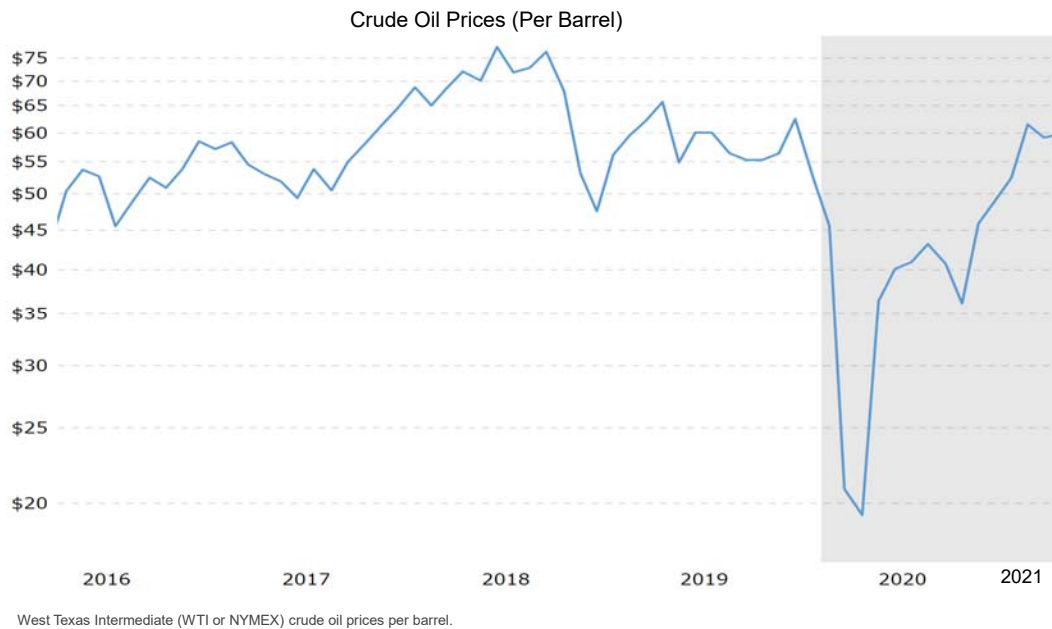

7

## Phase 2-Roundabouts Stage Construction

Stage 1:  
Utilities, and  
drainage  
UPRR  
Crossing  
2.5 months



Stage 2A:  
East  
roundabout  
(NE Quad)  
2 months



Stage 2B:  
East  
roundabout  
(SE Quad)  
2 months



Stage 3: West Roundabout 2<sup>nd</sup> Street  
4 months



Stage 4: Reconstruction at Gilman/  
I-80 Undercrossing  
2 months

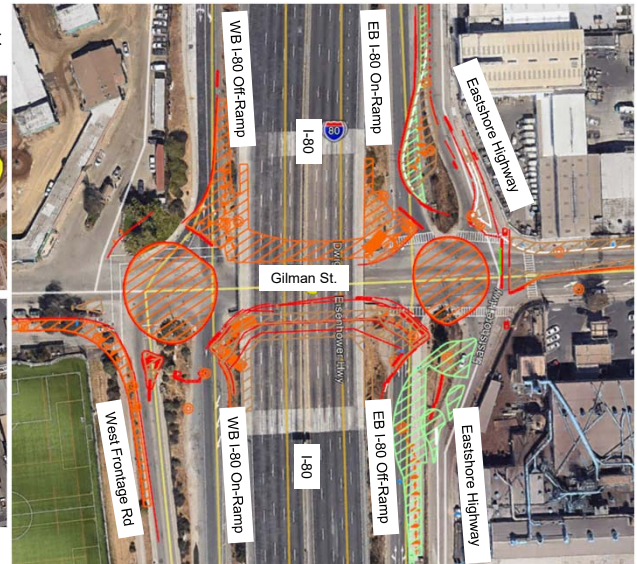

Stage 5- Stage 8: Miscellaneous work near roundabout  
5 months

For illustrative purposes only.

8

## Challenges - Utilities

### » Relocation

- PG&E Electric & AT&T OH Facilities into UG Joint Trench – 2,650 LF (Prior to Construction)
- Caltrans 10" RCW Line – 1,010 LF

### » Protect in Place

- EBMUD 36" Sewer Force Main
- Kinder Morgan 8" & 10" Oil Lines

### » Construct

- EBMUD 12" RCW Line – 2,440 LF
- City of Berkeley 6" Sanitary Sewer (Gravity & Force) - 970 LF

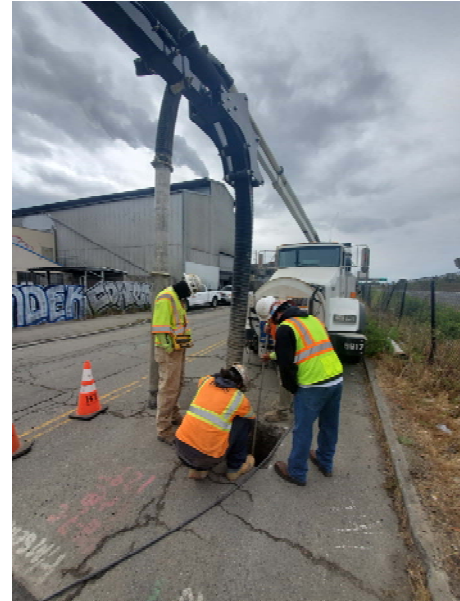

9

## Challenges - Coordination

### » Stakeholders

- California Transportation Commission
- Caltrans
- City of Berkeley
- City of Albany
- East Bay Regional Parks District
- Federal Highway Administration
- General Public



### » Adjacent Facilities

- Golden Gate Fields
- Tom Bates
- Bay Trail
- Local Businesses

Stakeholders

Utilities

### » Utilities

- PG&E, AT&T
- EBMUD
- City of Berkeley
- Kinder Morgan

Right of Way

UPRR



### » UPRR

- Single vs. Multiple Mobilizations

Contractors

### » Contractors

- Phase 1- Golden State Bridge
- Phase 2- TBD
- Barrier Project-Vanguard

10

## Schedule - Construction

May 2020

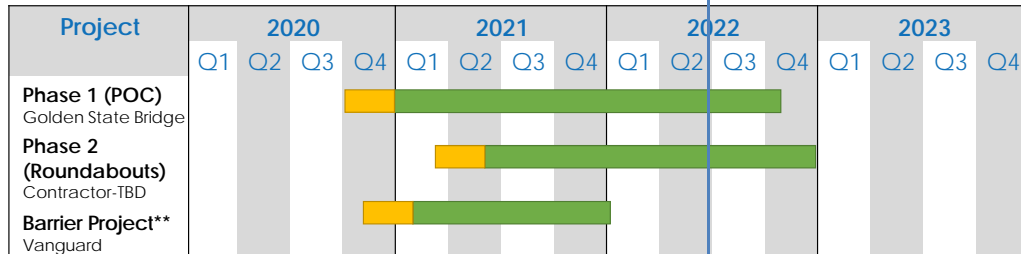

April 2021

Advertise/Award



Construction

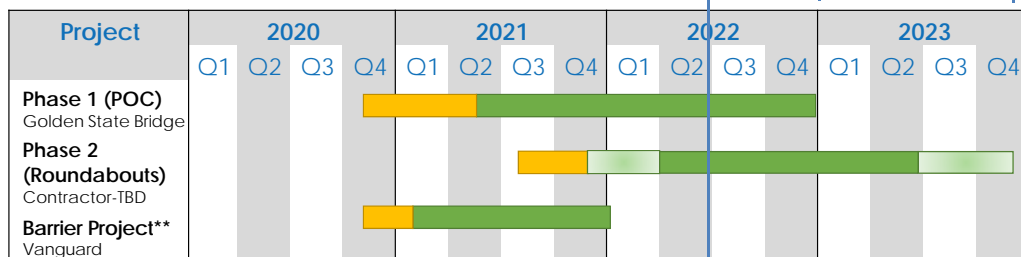

\* All information shown is tentative and subject to change  
 \*\* Caltrans median Barrier Lighting Project

Furlough Rates

11

## Gilman Project Funding Need

PURPOSE	Others*	MBB- TEP 26
Phase 2 construction contract cost estimate update	\$643,800	\$3,964,300
PG&E and UPRR	\$0	\$1,900,000
<b>CAPITAL Subtotal</b>	<b>\$643,800</b>	<b>\$5,864,300</b>
Caltrans support	\$0	\$1,672,000
PTG support	\$134,500	\$2,065,500
RON process and fees	\$0	\$500,000
<b>SUPPORT Subtotal</b>	<b>\$134,500</b>	<b>\$4,237,500</b>
<b>TOTAL FUNDING NEED</b>	<b>\$778,300</b>	<b>\$10,101,800</b>

\*City of Berkeley Funding from Measure T1 FY23 (\$319,500)  
 EBMUD ( \$458,800)

12



# Recommendation

For the Construction of the Gilman Interchange Improvements Project:

1. Approve allocation of \$10,101,800 of Measure BB funds from the Congestion Relief, Local Bridge, Seismic Safety program (TEP-26) for the Project (\$5,864,300 capital, \$4,237,500 support); and
2. Authorize the Executive Director or designee to execute Amendment No. 7 to Professional Services Agreement No. A15-0034 with Parsons Transportation Group, Inc. (PTG) for an additional amount of \$2,200,000 for a total not-to-exceed amount of \$13,873,000 to complete the design for Phase 2 of the Project, inclusive of right-of-way (R/W) acquisition and bid support services, and to provide design support services during construction (DSDC) for Phase 1 and Phase 2.
3. Authorize the Executive Director or designee to enter into all necessary agreements to achieve Project commitments.



For illustrative purposes only.



Alameda County Transportation Commission • 1111 Broadway, Suite 800  
Oakland, CA 94607 • 510.208.7400